

# from the field



think inside the box.

## Keywatcher Integration with Lenel Access Control

A MORSE WATCHMANS CASE STUDY



### OVERVIEW

Morse Watchmans have been known as an innovator of high-quality, cost-effective technology for over a century. Through seamless design, manufacturing and support, we earned the reputation as the world leaders in security management products. Specialising in state of the art key management (KeyWatcher), guard tour (PowerCheck) and Tamper-Proof KeyRings, our products are reliable, easy to use and expandable to meet your growing needs.

Lenel Systems International is a leading provider of software and security systems for

corporate and government markets. Lenel focusses on developing products that enable organisations to effectively perfect and manage their people,

property and assets by maximising I.T. and infrastructure investments.

Lenels' expertise have been able to provide 'Morse Watchmans' KeyWatcher with the integration package illustrated below, in order they comply with legislation for various industries.

Dryad-Hudson is a partnership of Wolseley U.K, and the Hudson (Group) Ltd ,developed in

order to provide a global Ironmongery and Security design package direct to Dryads' customer base introducing the full supply and installation of all products rather than a material provision only.

Hudson being a "Value Added Reseller" for Lenel Systems International with Lenels' expertise have been able to provide "Morse Watchmans" Keywatcher with the integration package illustrated below in order

### KeyWatcher Integration with Lenel Access Control System

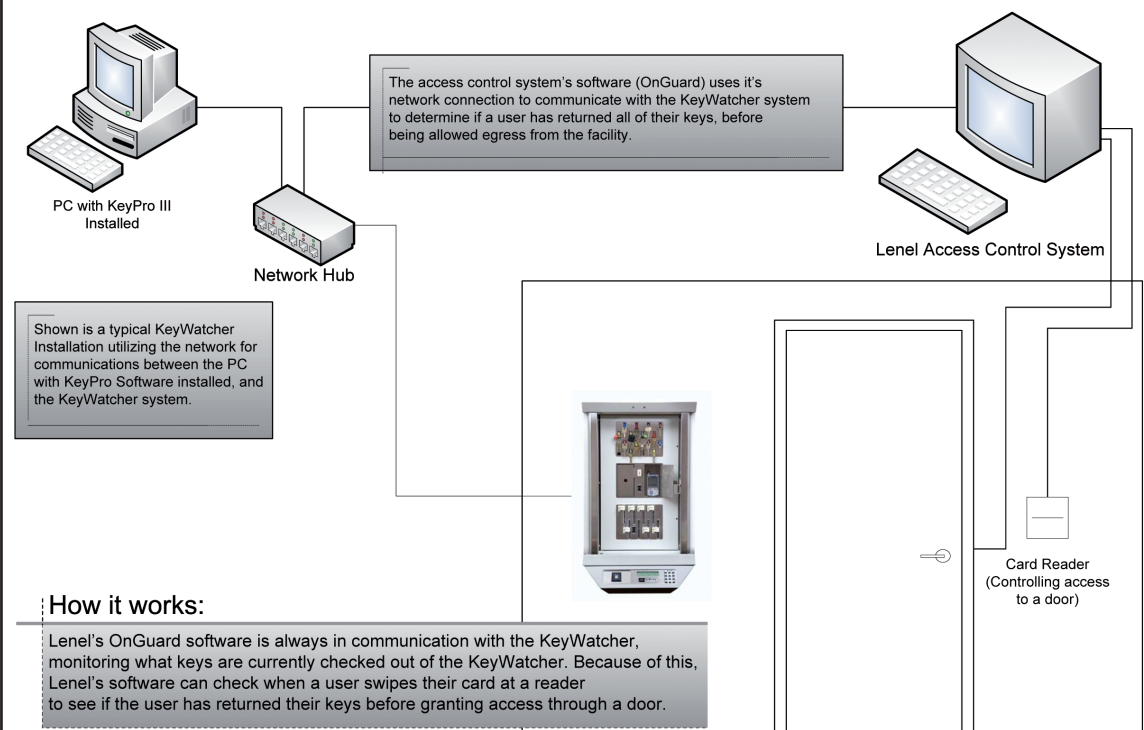

that they can comply with legislation.

### PROBLEM AND SOLUTION

A preventative measure from removing keys off site was needed. This needed to incorporate an electronic solution to reduce man hours, to prioritise work load and eliminate human error. After assessing feedback from various industries and companies a system was required to facilitate a KeyWatcher to produce accurate reporting, backed up with preventative measures of

keys not being removed from a controlled perimeter. Allocated keys will only allow users to walk off site through an air lock with their key being returned first, to the KeyWatcher.

The basics of this function must allow for any customers needs, such as any individual security applications and any future expansions.

### THE SOLUTION

To bring together recognised market leaders in their industries such as electronic key

management systems, installers / suppliers of security hardware and security software. To interface the keywatcher system with various access control systems, using a frontend database. The area of movement for staff with keys would be defined by the parameters within the building controlled by various access controlled doors.

### THE RESULTS

The electronic integration is intended to work as a self running, stand alone system allowing staff more time to concentrate

on their own duties. The only time intervention is needed is when an alarm is activated requiring attention to deal with any issues raised. Through the database provided it can offer various security parameters that can be applied to users, keys, bunches of keys, time restraints, reservations and notes etc.

## KEY FEATURES AND BENEFITS

- CUSTOM BUILT SYSTEM
- EXPANDABLE SYSTEM
- MAINTENANCE CONTRACTS
- A PROFESSIONAL INSTALLATION
- USER FRIENDLY HARDWARE AND SOFTWARE
- ILLUMINATED KEY STORAGE
- ADVANCED NETWORK CAPABILITIES
- REAL TIME TRANSACTION POLLING
- CENTRALISED PROGRAMMING
- UP TO 2,000 USER CODES
- BIOMETRIC ACCESS OPTIONS
- SECURE SINGLE KEY ACCESS
- SECURE SLOT AND LOCKER OPTIONS
- TAMPERPROOF MECHANISMS
- KEY CAN BE RETURNED TO ANY LOCATION
- KEYS ARE EASY TO IDENTIFY
- SINGLE FRONTED DATABASE
- CENTRALISED PROGRAMMING
- EXTENSIVE AND DETAILED REPORTING OPTIONS
- NOTIFICATION ALERTS
- AUDIBLE ALARM NOTIFICATION
- PRIORITY EMAIL ALERTS
- KEY RESERVATIONS
- AUTOMATIC TRANSACTION COLLECTION
- USER PASSWORD SECURITY
- DELETE USER
- REMOTE KEY REMOVAL
- NOTES TO DEFINE KEY REMOVAL AND RETURN